

Information on the German Host Institution

Combined Study and Practice Stays for Engineers from Developing Countries (KOSPIE) – Tunisia – 2026-2028

1. Technische Universität Dresden

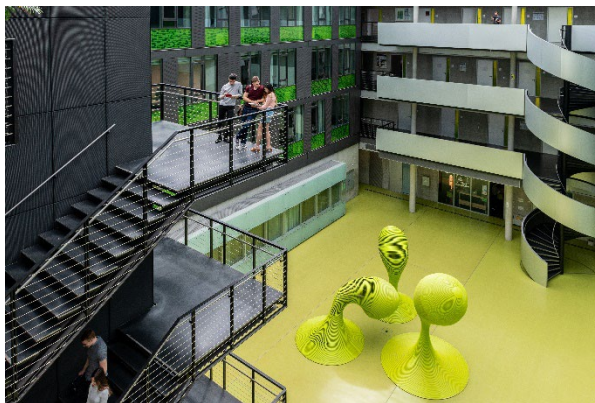

Visit our website: <https://tu-dresden.de/why-tud>

2. General information on the institution

2.1 Institution has been accredited by:

<https://www.hochschulkompass.de/en/higher-education-institutions.html>

2.2 Does your institution follow the Code of Conduct for exchange programmes?

Yes No

2.3 Welcome programmes for exchange students:

Services for KOSPIE students:

- Welcome meeting for KOSPIE students
- English-speaking KOSPIE tutors to assist with administrative processes, help with the organisation of studies (e.g. setting up a timetable, registration for exams), and support students in personal matters (e.g. arrival and departure, accommodation, visits to the doctor)
- Cultural programme for KOSPIE students with excursions in the region

Further information on selection of courses and the study project is available at the TU Dresden KOSPIE programme website:

<https://tu-dresden.de/studium/vor-dem-studium/internationales/stipendien/kospie-daad/daad-kospie-tunesien>

Services for international students in general:

- Accommodation in student dorms (single rooms in flat shares) near campus and reasonably priced (<https://www.studentenwerk-dresden.de/english/wohnen/wohnheimkatalog/>)
- Student canteens and cafeterias
- Tutor programme with individual help for all international students
- Buddy and mentoring programmes (general and on faculty-level), student-led activities, and welcome events organised by participating faculties and schools
- Language courses for TUD students (free of charge) that can be used to continue learning German or to learn other languages, see <https://tu-dresden.de/gsw/slk/lsk/sprachen-fuer-alle-studiengaenge>
- Dresden University Sports Centre (DHSZ), see <https://tu-dresden.de/dhsz>

2.4 Location of institution:

Dresden, capital of the Free State of Saxony, Germany

2.5 Special attractions for young people:

Affectionately known as 'Florence on the Elbe', Dresden counts among Germany's most liveable cities.

It is home to famous art collections and museums, a magnificent historic city centre as well as theatres, concert halls, and the world-renowned Semper Opera.

Trendy pubs and student clubs in the city's Neustadt district attract young people from all over the world.

The beautiful Elbe valley, the Elbe Sandstone Mountains, and the Erzgebirge/Ore Mountains provide limitless outdoor adventure opportunities.

Other cities such as Berlin, Leipzig, Prague (Czech Republic) and Wroclaw (Poland) are easy to reach by car or train.

For more see: <https://tu-dresden.de/why-tud>



2.6 Costs of living (dorms etc.):

Average student dorm rent per month	290 EUR (furnished)
Average rent in private housing	Shared apartment: 300 – 400 EUR / month (mostly unfurnished)
Semester contribution / fee	288,10 EUR (winter semester 2024/25)
Public transportation	Included in the semester contribution, includes use of Mobi Bikes (bicycles)
Average expenses	600 – 800 EUR / month (including housing, public transportation, other living expenses)
Meal at the canteen / cafeteria	2,30 EUR – 4,50 EUR

A deposit must be paid before signing the tenancy agreement in the student residence (200 - 400 EUR). This amount will be repaid at the end of the tenancy.

3. Combined study and practice stays for engineers from developing countries (KOSPIE) – Tunisia

3.1 Faculties, institutes and potential supervisors participating in the exchange programme offered:

Within the frame of DAAD KOSPIE Tunisia, scholarship holders carry out research at an institute or chair at TU Dresden (English-speaking academic supervisors).

In their application applicants have to **specify an Institute or Chair at TU Dresden** in which they would like to carry out their research. The **research areas of the chosen Institutes or Chairs** should be related to the applicant's study course in Tunisia and especially with the applicant's end-of-year project (projet de fin d'études). Applicants should research independently which **research areas** the institutes listed below focus on and then **select a suitable institute as well as a suitable supervisor**.

It is **not necessary** for the Tunisian applicants to **contact a desired academic supervisor** at the time of application. In the **DAAD application form**, only the **name of the desired Institute (or Chair)** and the **name of the desired academic supervisor** for the study stay at TU Dresden have to be indicated. The matching, i.e. the concrete request for supervision, is done by the International Office of TU Dresden for all applicants.

[Faculty of Electrical and Computer Engineering](#)

[Faculty of Computer Science](#)

[Faculty of Mechanical Science and Engineering](#)

[Faculty of Civil Engineering](#)

[Faculty of Environmental Sciences](#)

[Faculty of Transport and Traffic Sciences](#)

[Faculty of Business and Economics / Chair of Business Information Systems](#)



It is also possible to apply for places that have been confirmed specifically for the KOSPIE Tunisia programme (intake 2026, 2027, 2028). Please check the KOSPIE programme website for more information.

<https://tu-dresden.de/studium/vor-dem-studium/internationales/stipendien/kospie-daad/daad-kospie-tunesien>

3.2 Students of the following degree courses may join the exchange programme:

Students in the Engineering Sciences (including IT) at government or government recognised universities in Tunisia (Mastère de recherche or diplôme)

3.3 Tuition/semester fees (if applicable):

Yes No

TU Dresden is a public university and does not charge any tuition fees. The semester fee of 288,10 EUR/semester (winter semester 2024/25) has to be paid by all students and includes a ticket for public transport.

3.4 Near-by companies with which co-operations are withheld:

Infineon, Global Foundries, Volkswagen, Siemens, GlaxoSmithKline GmbH and many more.

TU Dresden is a member of many networks, for example Silicon Saxony e.V. (<https://www.silicon-saxony.de/en/home/>) and Biosaxony (<https://www.biosaxony.com/en>). Within DRESDEN-concept, TU Dresden cooperates with various Fraunhofer, Max Planck, Leibniz and Helmholtz research institutes in Dresden.

3.5 Established partnerships with the following Tunisian higher education institutions and faculties (if applicable):

Current (research) cooperation:

- Université La Manouba, Ecole Nationale des Sciences de l'Informatique – ENSI (research cooperation)
- Université de Sfax (research cooperation)
- University of Carthage, Bizerte (research cooperation)

3.6 Interest in exchange with the following Tunisian higher education institutions (please specify faculties, if applicable):

- **Université de Carthage** (Ecole Nationale d'ingénieurs de Bizerte, Institut Supérieur de Construction et d'Urbanisme, Institut Supérieur des Technologies de l'Environnement, de l'Urbanisme et du Bâtiment)
- **Université de Tunis El Manar** (Ecole Nationale d'Ingénieurs de Tunis, Institut Supérieur d'Informatique)
- **Université de Sfax** (Ecole Supérieure d'Electronique et des télécommunications, Ecole Nationale d'Ingénieurs de Sfax)
- **Université de Sousse** (Ecole Nationale d'Ingénieurs de Sousse, Institut Supérieur d'Informatique et des Technologies de Communication de Hammam Sousse, Institut Supérieur du Transport et de la Logistique Sousse)
- **Université La Manouba – UMA** (Ecole Nationale des Sciences de l'Informatique – ENSI)



3.7 Further remarks or special services (e.g. about the housing situation):

TU Dresden has been accepting scholarship holders as part of the KOSPIE programme for several years. In recent years, all KOSPIE scholarship holders have received a place in a hall of residence.

Study period at TU Dresden: **1 February – 31 July** (an earlier or later start is not possible)

In their application, applicants have to **specify an Institute or Chair at TU Dresden** in which they would like to carry out their research. The **research areas of the chosen institutes or chairs** should be related to the applicant's study course in Tunisia and especially with the applicant's end-of-year project (projet de fin d'études).

Information about **Institutes and Chairs involved** in the DAAD KOSPIE programme at TU Dresden and the **application procedure** is available at the following website:

<https://tu-dresden.de/studium/vor-dem-studium/internationales/stipendien/kospie-daad/daad-kospie-tunesien>

What language skills are required?

English (at least B1)

4. Responsible contact person(s)

4.1 Contact person at university-level and/or at faculty level

Peter Rosenbaum
Head of the Staff Unit International Affairs / International Office
Technische Universität Dresden

4.2 Contact person student coordinator/advisor

Technische Universität Dresden
International Office
Incoming Student Mobility / Scholarship Programmes
Maximilian Schurig (KOSPIE student coordinator/advisor)
Phone: +49 (0)351 463 32442
E-mail: maximilian.schurig@tu-dresden.de

Technische Universität Dresden
International Office (KOSPIE program coordinator)
Incoming Student Mobility / Scholarship Programmes

Cornelia Hesse
Phone: +49 (0)351 463 36330
E-mail: cornelia.hesse@tu-dresden.de